



Eliot Quarry SMP-23 Reclamation Plan Amendment Project Lake A Meeting

JUNE 26, 2019





Lake A Mining

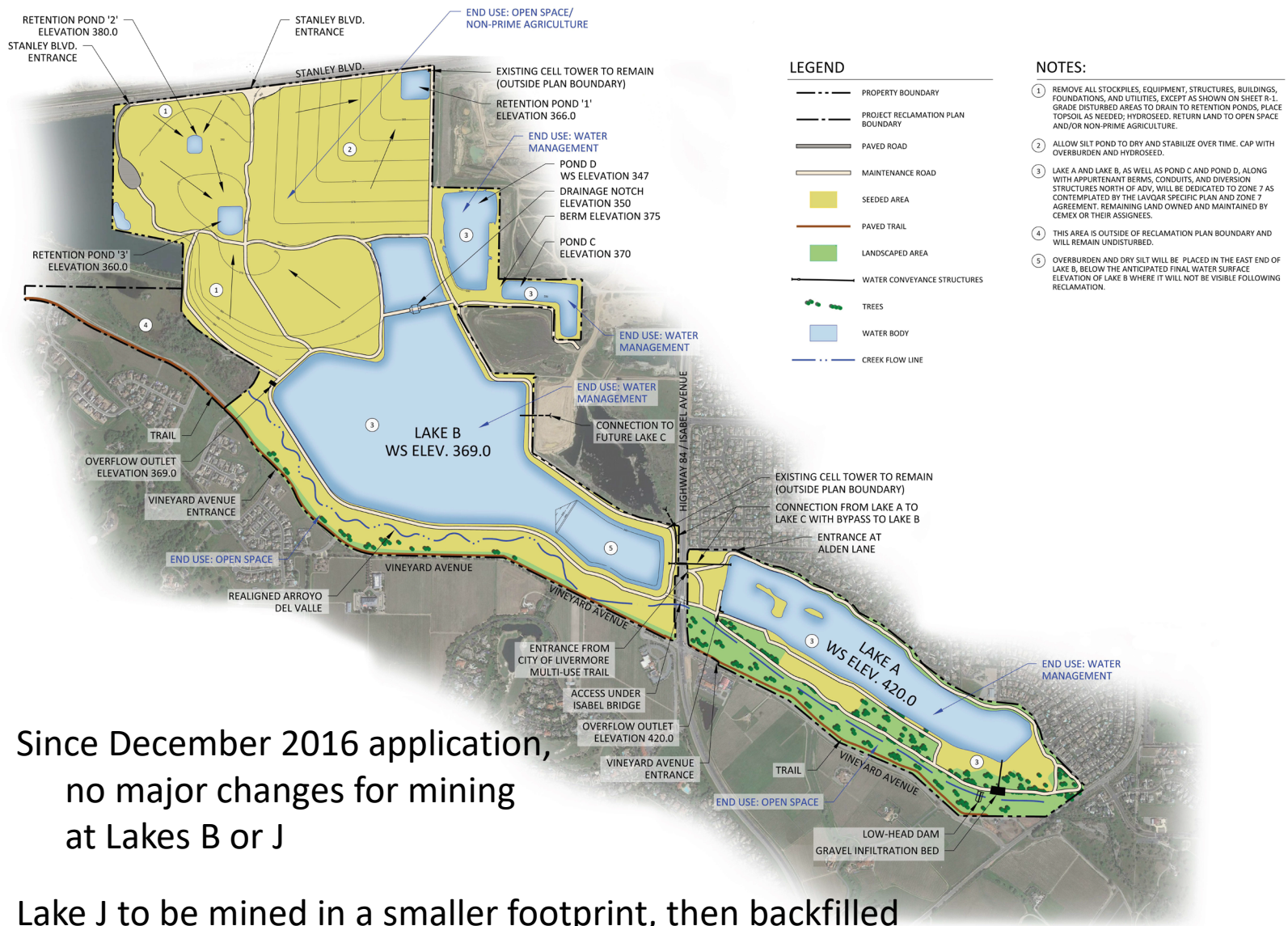

2365 IRON POINT ROAD
SUITE 120
FOLSOM, CA 95630

**RECLAMATION PLAN
ELIOT FACILITY
SMP-23**

ALAMEDA COUNTY
CALIFORNIA

JANUARY 2019

**UNAPPROVED
PROPOSED
DRAFT**

**CEMEX
ELIOT FACILITY**

1544 STANLEY BOULEVARD
PLEASANTON, CA 94566

CA MINE ID NO: 91-01-0009

REVISIONS	
REV	DESCRIPTION

DESIGNED: _____

DRAWN: _____

CHECKED: _____

APPROVED: _____

FILENAME: 2018 ELIOT

SA PROJECT NUMBER: 150.00

CLIENT PROJECT NUMBER: _____

**RECLAMATION
PLAN
OVERVIEW**

DRAWING NUMBER: **R-5**

SHEET NUMBER: **8 OF 8**

Since December 2016 application,
no major changes for mining
at Lakes B or J

Lake J to be mined in a smaller footprint, then backfilled
for return to agriculture and/or open space

So What IS Planned for Lake A?

- Finish reclamation and transfer Lake A to the Zone 7 Water Agency
- Reclamation is required per County Code and State law
- Reclamation is not mining, but the process for returning mined lands to a beneficial end use:

A water management lake to be operated by the Zone 7 Water Agency

- Reclamation will involve short-term, small crew construction projects spread over two years (e.g., install pipelines, berms, landscaping plantings)

Construction at much smaller scale than Caltrans' Isabel Ave. widening, with less equipment, less traffic, and less inconvenience

Mitigating Impacts of Reclamation Work on Neighbors

- Construction is planned to be phased over two years
- Reclamation will occur during the day to avoid noise and light at night
- No sand and gravel will be exported out of Lake A
- Construction will adhere to a dust control plan, with best practices
- Water trucks will be used daily
- Construction Storm Water Pollution Prevention Plan (SWPPP) will be implemented
- Disturbed surfaces will be vegetated with an erosion control cover

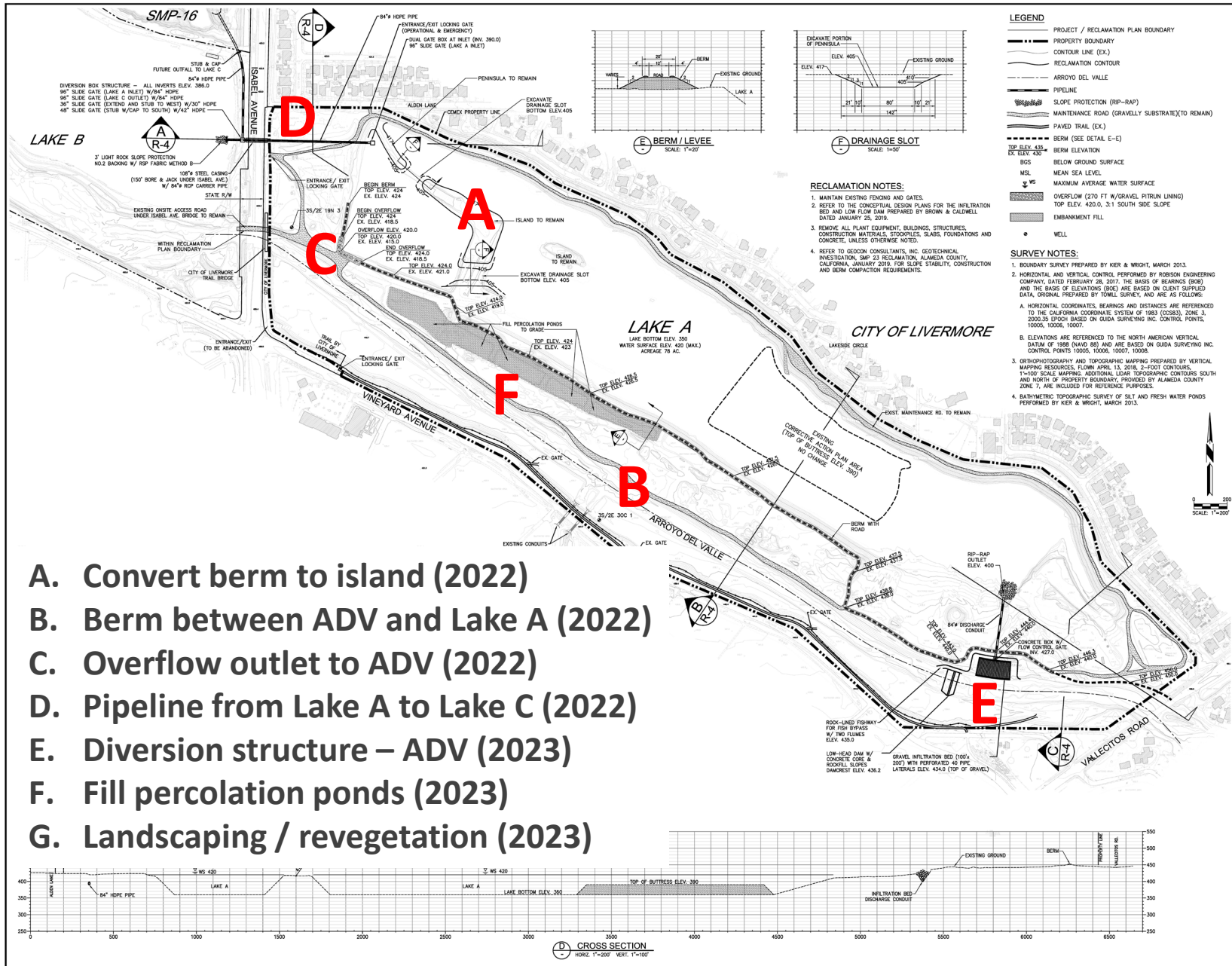

- A. Convert berm to island (2022)
- B. Berm between ADV and Lake A (2022)
- C. Overflow outlet to ADV (2022)
- D. Pipeline from Lake A to Lake C (2022)
- E. Diversion structure – ADV (2023)
- F. Fill percolation ponds (2023)
- G. Landscaping / revegetation (2023)

Spinardi Associates
Civil and Environmental Engineering
265 Sea View Avenue
Piedmont, CA 94610

CEMEX
2385 IRON POINT ROAD
SUITE 120
FOLSOM, CA 95630

**RECLAMATION PLAN
ELIOT FACILITY
SMP-23**

ALAMEDA COUNTY
CALIFORNIA

JANUARY 2019

**UNAPPROVED
PROPOSED
DRAFT**

**CEMEX
ELIOT FACILITY**

1544 STANLEY BOULEVARD
ALAMEDA COUNTY, CA
94606

CA MINE ID NO. 91-01-0009

REV.	DATE	REVISIONS	DESCRIPTION

DESIGNED: KDS
DRAWN: DR/MLWH
CHECKED:
CHECKED:
APPROVED:

FILENAME: 2018 ELIOT
S:\PROJECTS\KASBERN\180309
CLIENT PROJECT NUMBER:

**LAKE A
RECLAMATION
PLAN**

DRAWING NUMBER
R-4

SHEET NUMBER
8 OF 9

PLOT DATE 01/28/2019

A. Convert Berm to Island (2022)

Purpose:

- Allow water to flow across lake
- Improve aesthetic / habitat value

Duration: ~2 weeks

- 1 excavator loading 2 haul trucks
- Water truck used daily
- Crew size: 5, incl. grade setter
- Material will be used to construct berms at Lake A

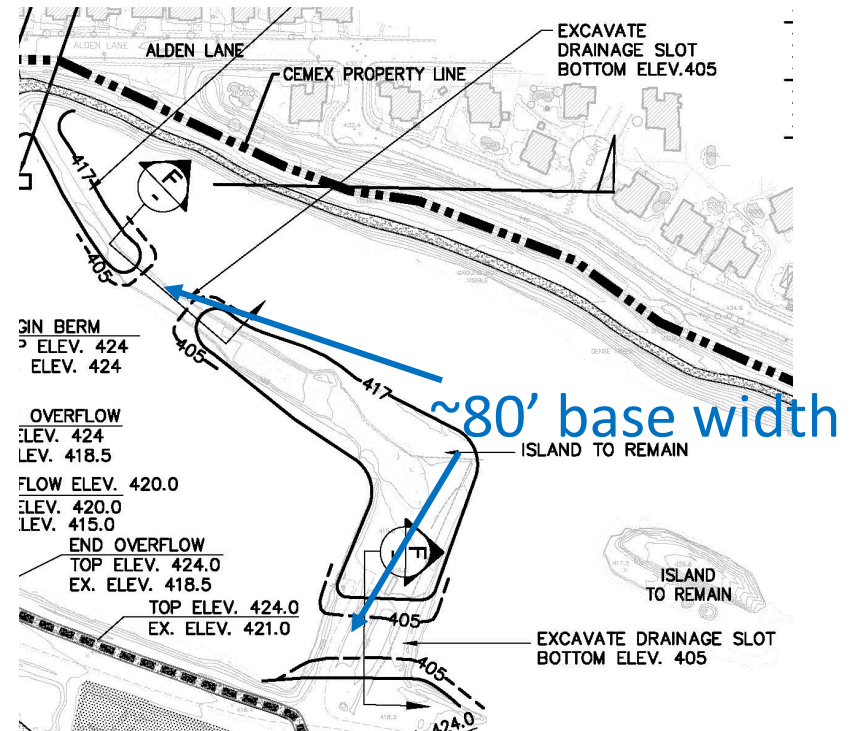

B. Berm Between Arroyo del Valle and Lake A (2022)

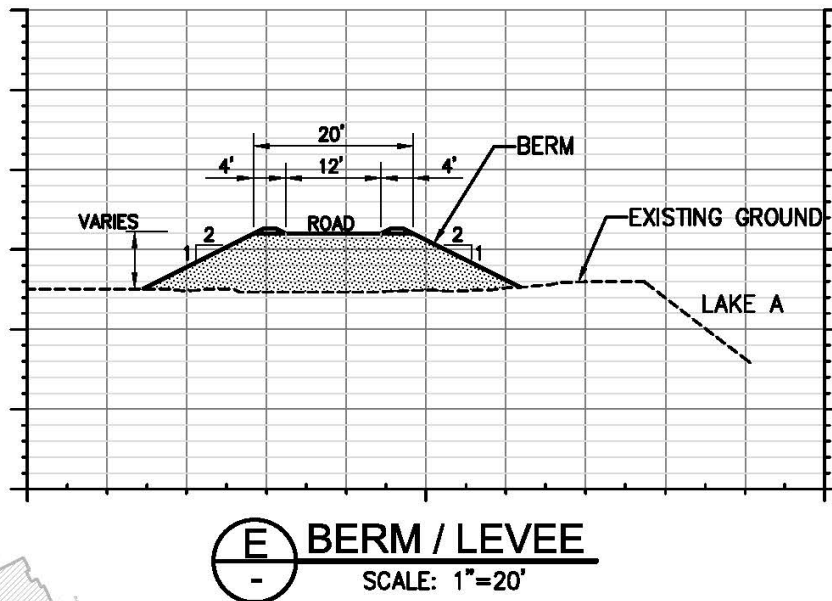

Purpose:

- 0-6' berm keeps Arroyo flows out of lake

Duration: ~2 weeks

- Loader, dozer, and compactor used to construct berm with available on-site material; motor grader for finish grade
- Water truck used daily
- Crew size: 6, incl. grade setter

C. Overflow Outlet to Arroyo del Valle (2022)

Purpose:

- Prevent flooding of adjacent properties if lake water levels rise

Duration: ~1 week

- 1 excavator and 1 loader to fine grade and place ~450 cubic yards of rip rap
- Water truck used daily
- Crew size: 6, incl. grade setter and laborer

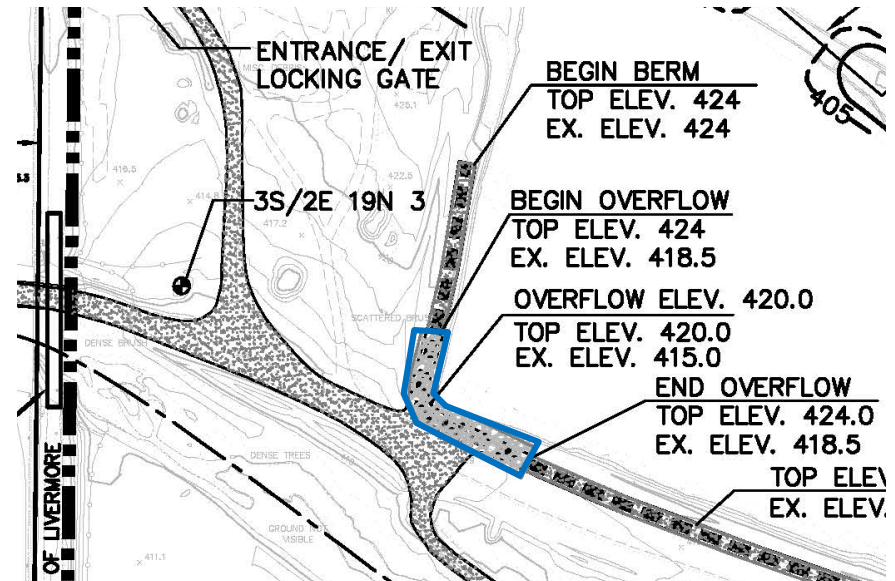

Overflow located at southwest corner of Lake, opposite of homes

D. Pipeline from Lake A to Lake C (2022)

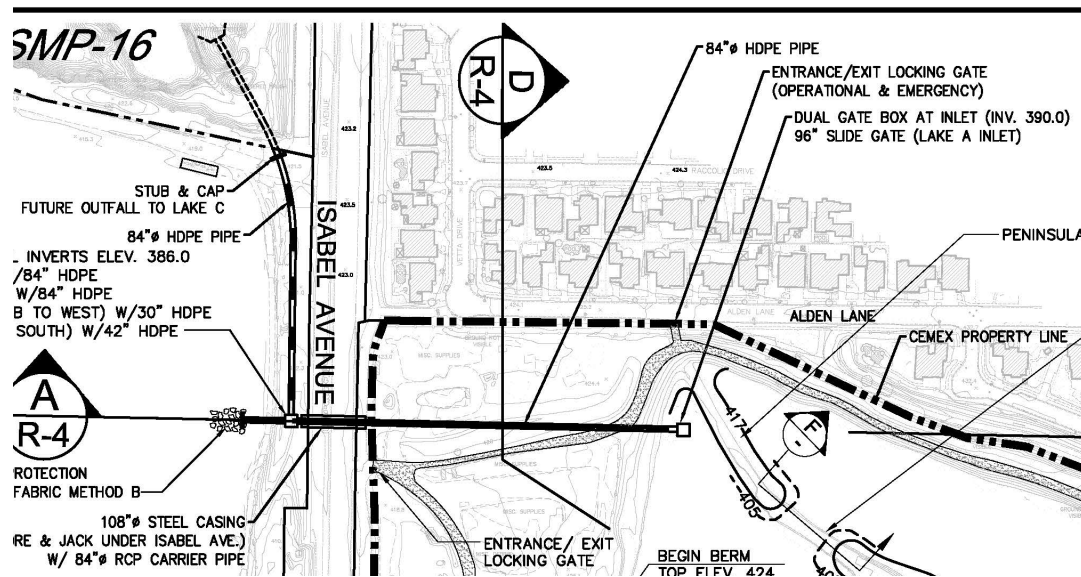

Purpose:

- Allow Zone 7 to move water into the Chain of Lakes

Duration: ~3 months

- ~1 month for cut-and-cover with scrapers, dozers, motor grader, and compactor
- ~2 months to jack-and-bore under Isabel, install vaults, lay pipes
- Water truck used daily
- Crew size: 5 – 13, task dependent

E. Diversion Structure – Arroyo del Valle (2023)

Purpose:

- Allow Zone 7 to move water from Arroyo into Lake A and Chain of Lakes

Duration: ~6 weeks

- 2 excavators, loader, roller, and fork lift for install
- ~50 cubic yards of concrete pour for low-head dam
- Water truck used daily
- Crew size: 5 - 9, task dependent

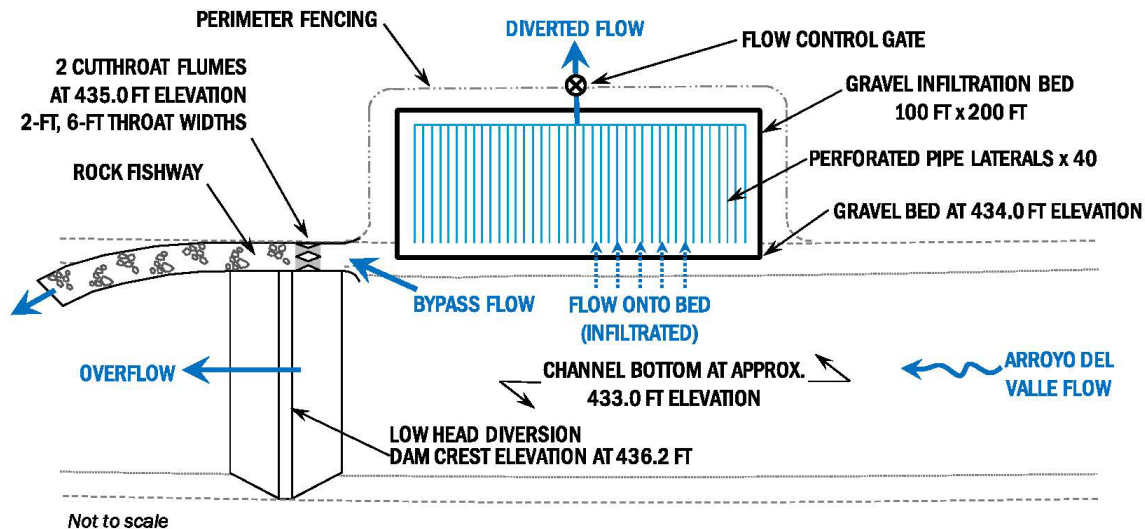

F. Fill Percolation Ponds (2023)

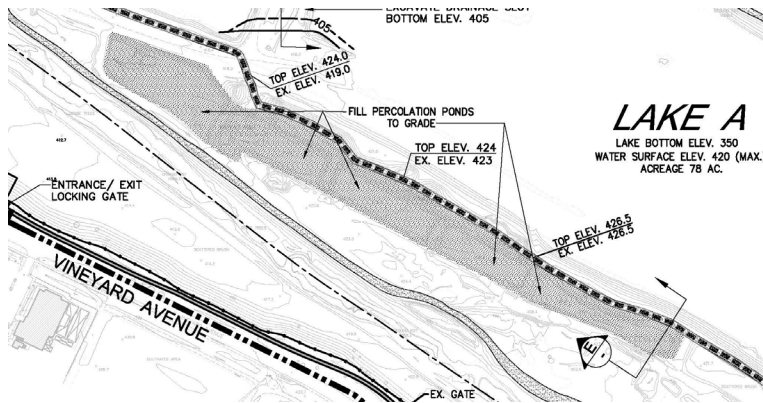

Purpose:

- Fill-in and grade artificial depressions using existing dirt piles

Duration: ~1 week

- 1 motor grader, 1 dozer, and 1 loader to fill and grade
- Water truck used daily
- Crew size: 5, incl. grade setter

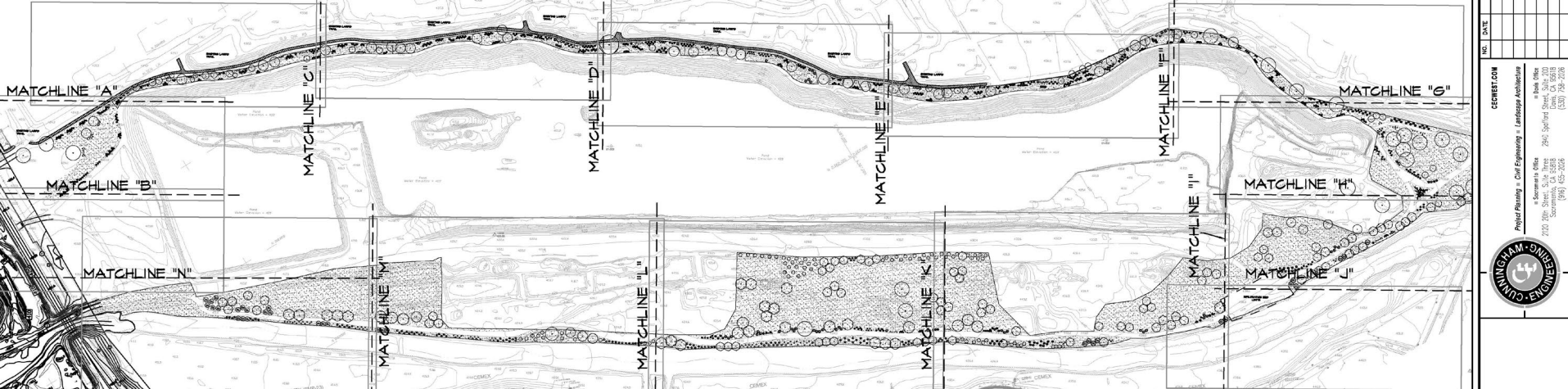

G. Landscaping and Revegetation – the last step! (2023)

Purpose:

- Incorporate California native, drought tolerant trees (~200), shrubs (~1,100), and grasses
- Improve aesthetic / habitat value

Duration: ~1 month

- Hydroseed truck and laborers
- Crew size: ~5, incl. laborers

TREES



WHITE ALDER



CALIFORNIA SYCAMORE



FREMONT COTTONWOOD



COAST LIVE OAK



VALLEY OAK



RED WILLOW



ARROYO WILLOW

SHRUBS



HOWARD McMINN MANZANITA



MULEFAT



BUTTONBUSH



WESTERN REDBUD



TOYON



COFFEEBERRY

SUB-SHRUBS



DWARF COYOTE BRUSH



CALIFORNIA FUCHSIA



STICKY MONKEY FLOWER



BLACK SAGE



Thank You for your Time!

- Eliot Quarry is an important resource to CEMEX, the Livermore Valley, and greater Bay Area
- We heard your concerns and revised our plans for **no more mining at Lake A**
- There's no catch – our goal is to complete reclamation at Lake A by 2023!

A 2022 start date allows ~2 years for County process and 1 year for construction planning, bids and contracting

- With this change, we would very much appreciate your support
- Please visit our website at Cemexeliotfacility.com where you can sign-up for updates, take a survey, and provide your feedback